



FPC(UK) Limited
Stourdale Road,
Portersfield Ind Est
Cradley Heath, West Midlands
B64 7BG

T 01384 633660 F 01384 633760
Email sales@fpc-uk.com
Website www.fpc-uk.com

Intumescent Pipe Collar (IPC range)

Description

A steel collar internally lined with Intumescent material that fits around plastic pipe work. The collar is hinged for ease of fit and secured with a clip fastener. Attachment to the wall or underside of the floor slab is by 6mm anchors fixing through integral steel lugs.

Fix to plasterboard ceilings/walls using hollow wall metal anchors. Such as Fixfirm M5 Ref A661-235



Suitable for use where plastic pipes pass through both walls or floor slabs. In a fire the Intumescent expands and closes the hole left by the collapsing pipe, so retaining the structures integrity. Ratings available 2, 3 and 4 hours.

Benefits

- Cost effective
- Easy to install on initial build or retro - fitting
- Available in wide range of sizes
- Finished in red for easy identification

Installation

Undo Clip and place collar around the pipe, close firmly by shutting the clip. Slide the collar along the pipe to form a seal with the wall or slab.

FireSure® Intumescent Mastic should be used as gasket material to take up any imperfections between the collar flange and the wall or floor slab. Preferred fixings should be by 6mm anchors or in the case of studded walls/plasterboard ceilings by cavity fixings such as Fixfirm hollow wall metal anchors Ref A661-235.

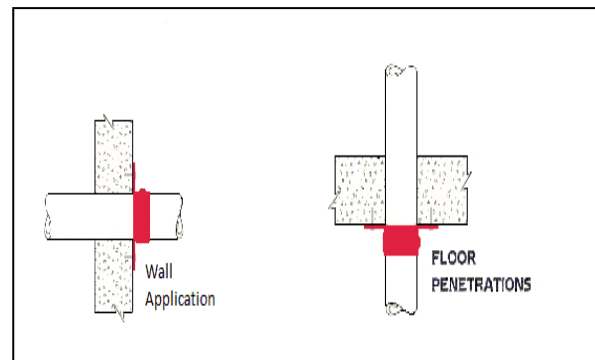

FPC Ref	Pipe OD mm	Fire Rating mins	Certificate No
IPC038	Up to 40	Up to 240	6 – FEI/F97033a
IPC055	55	Up to 240	6 - FEI/F97033a
IPC068	68	Up To 240	6 – FEI/97033a
IPC082	82	Up to 240	6 - FEI/F97033a
IPC110	110	Up to 240	6 - FEI/F97033a
IPC160	160	Up to 240	4 - FEI/F02047a

Now tested on 103mmØ 1.6mm thin wall ducting uncapped/uncapped in 100mm stud partitioning to BS EN 1363-1: 2012 and BS EN 1366-3: 2009. 1 each side to 132+ minutes – no failure.

Tested To BS: 476 Part 20-23 - BSEN 1363-1: 2012 - BSEN 1366-3: 2009
Health and Safety - No reportable hazard to health